

Pole Mount

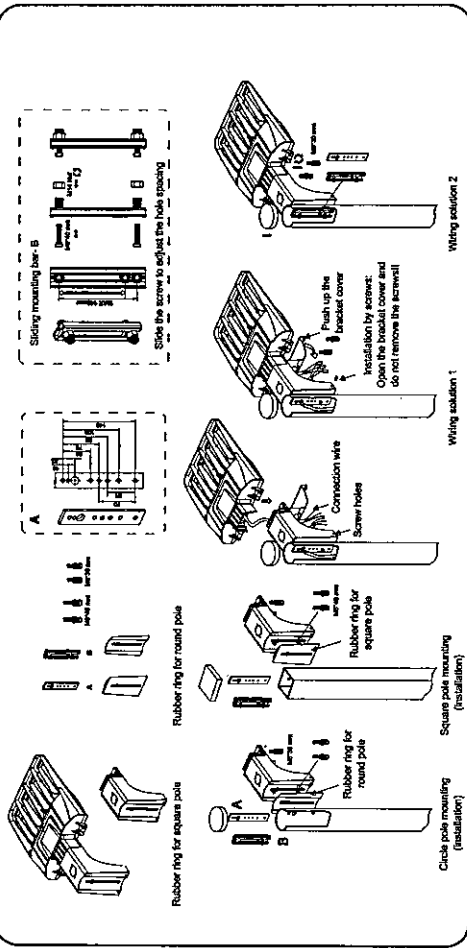

Slip Fitter

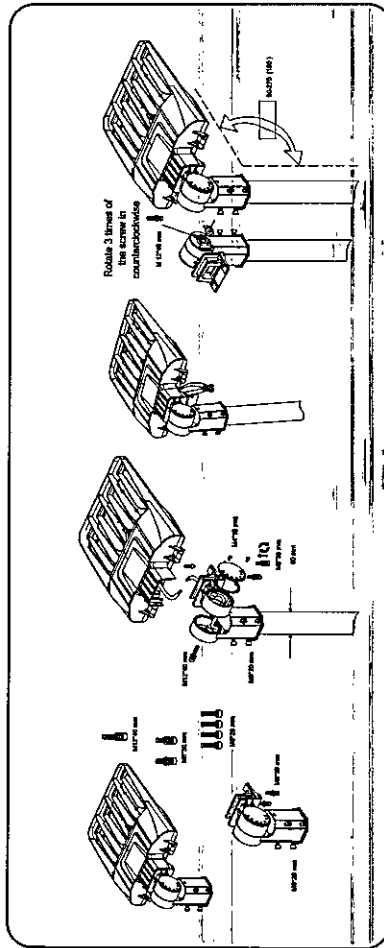

Trunnion

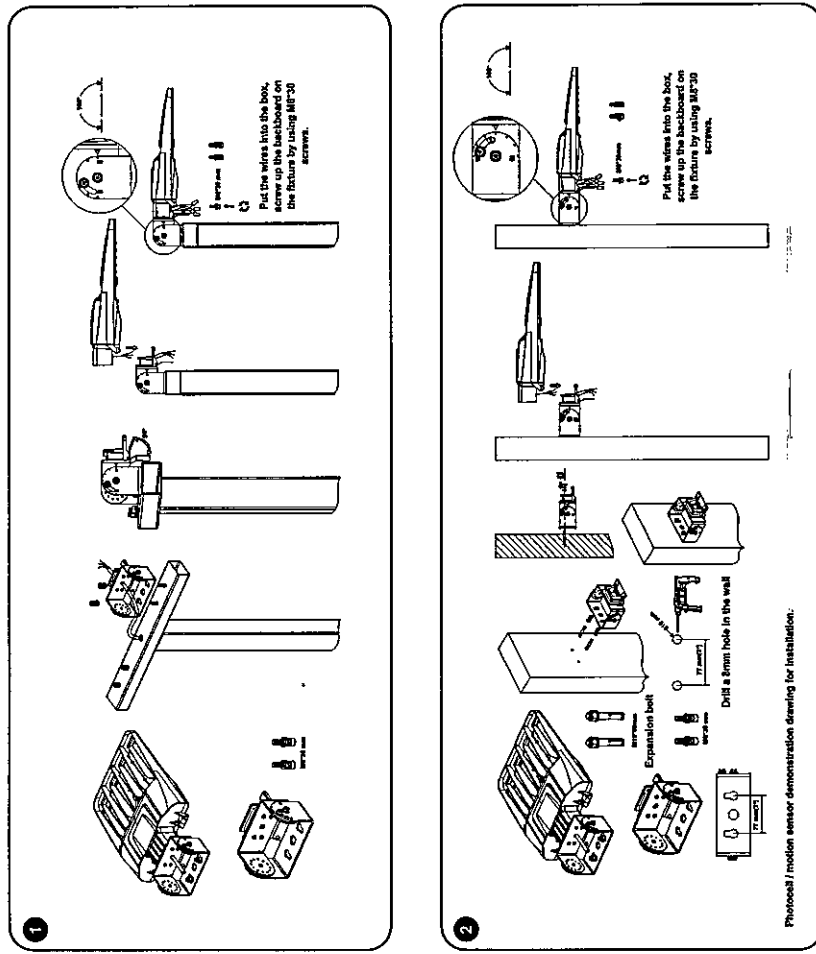

Demonstration Plan 1

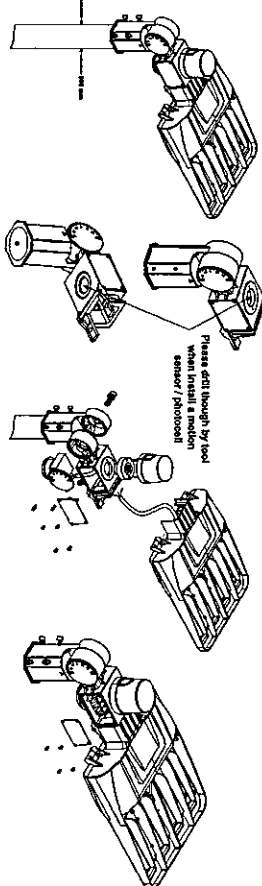

Demonstration Plan 2

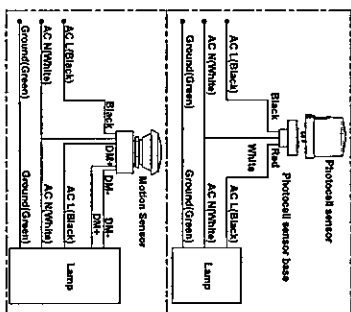
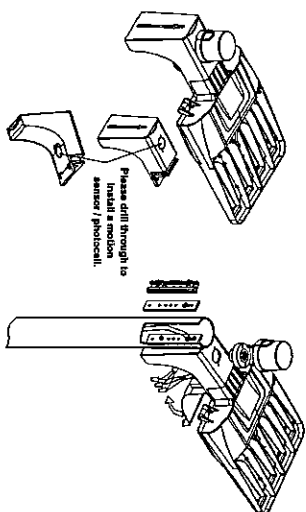

LED SHOEBOX Area Luminaires

Warning:

To avoid the risk of fire, explosion or electric shock, this product should be installed, inspected, and maintained by a qualified electrician only, in accordance with all the applicable electrical codes.

To Avoid Electric shocks:

- Be certain electrical power is switched off before and during its installation and maintenance.
- Luminaire must be connected to a wiring system with an equipment-grounding conductor.

To Avoid Explosion:

- Make sure the supply voltage is the same as the rated luminaire voltage.
- Do not install where the marked operating temperatures exceed the ignition temperature of the hazardous atmosphere.
- Do not operate in ambient temperatures above those indicated on the luminaire nameplate.
- Keep the lens tightly closed when in operation.

For supply connections use wire rated for at least 90°C

After installation, please

- Check whether the lighting fixture is firmly fixed.
- Check whether wires are connected correctly.
- After, turn on the power, and check for if the lighting fixture works well. If not, please turn off the power and contact with local dealer

Arm Mount

